

1544000mE
3679000mN

1544000mE
3678000mN

1544000mE
3677000mN

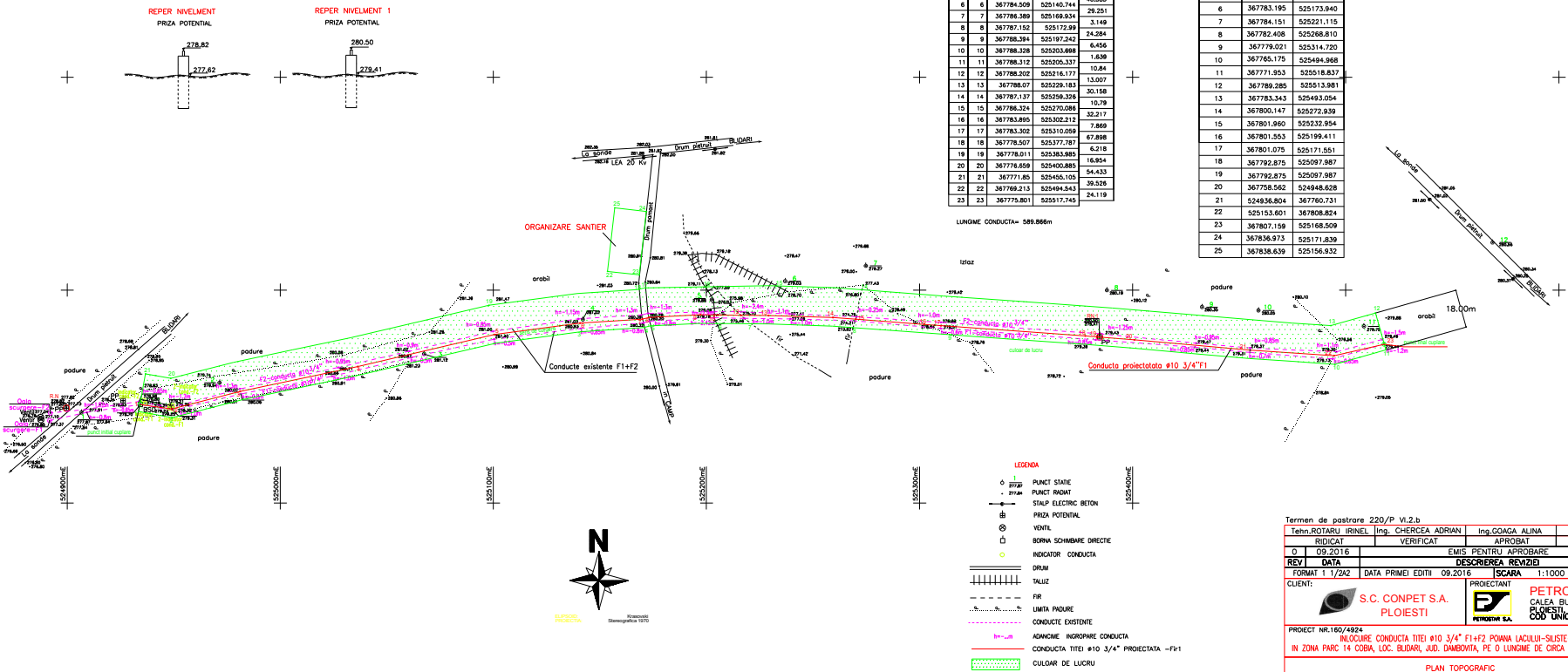

CONDUCTA PROIECTATA-FIR1				
NR	DEN PUNCT CRT	COORDONATE		DIST [m]
		X[m]	Y[m]	
1	1	367743.027	524933.556	15.082
2	2	367740.146	524949.264	33.109
3	3	367780.526	525141.139	56.354
4	4	367782.534	525171.010	65.916
5	5	367783.195	525173.840	40.385
6	6	367783.195	525173.840	29.251
7	7	367784.151	525221.115	3.149
8	8	367782.408	525268.810	24.284
9	9	367779.021	525314.720	6.456
10	10	367788.328	525203.688	1.538
11	11	367788.312	525205.337	10.84
12	12	367788.302	525216.177	13.007
13	13	367788.027	525229.183	30.158
14	14	367787.137	525258.226	10.79
15	15	367786.324	525270.086	32.217
16	16	367783.895	525302.212	7.569
17	17	367783.302	525310.059	67.898
18	18	367776.507	525377.787	6.218
19	19	367776.011	525383.885	16.954
20	20	367776.659	525400.885	54.433
21	21	367771.85	525455.105	39.526
22	22	367769.213	525494.343	24.119
23	23	367775.801	525517.745	

COORDONATE CULCAR DE LUCRU		
NR CRT	X[m]	Y[m]
1	367743.027	524933.556
2	367740.146	524949.264
3	367780.526	525141.139
4	367782.534	525171.010
5	367783.195	525173.840
6	367783.195	525173.840
7	367784.151	525221.115
8	367782.408	525268.810
9	367779.021	525314.720
10	367788.328	525203.688
11	367788.312	525205.337
12	367788.302	525216.177
13	367788.027	525229.183
14	367787.137	525258.226
15	367786.324	525270.086
16	367783.895	525302.212
17	367783.302	525310.059
18	367776.507	525377.787
19	367776.011	525383.885
20	367776.659	525400.885
21	367771.85	525455.105
22	367769.213	525494.343
23	367775.801	525517.745

LUNGIME CONDUCTA= 589.886m

LEGENDA

- PUNCT STATE
- PUNCT RADAT
- STALP ELECTRIC BTION
- PRIZA POTENTIAL
- VENTIL
- BORNA SCHIMBARE DIRECTIE
- INDICATOR CONDUCTA
- DRUM
- TAUZI
- FR
- LIMITA PADURE
- CONDUCTE EXISTENTE
- ADNACIUNE INGRAPARE CONDUCTA
- CONDUCTA TITEI #10 3/4" PROIECTATA -FIR1
- CULCAR DE LUCRU

Termen de pastare 220/P V.2.b

Tehn.ROTARIU IRINEL	Ing. CHERCEA ADRIAN	Ing.COAGIA ALINA	Ing. TOADER N.
PROIECTAT	VERIFICAT	APROBAT	SEF. PROIECT
0	09.2016	EMIS PENTRU APROBARE	
REV	DATA	DESCRIEREA REVIZIEI	
FORMAT 1 1/2A2	DATA PRIMEI EDITII 09.2016	ISCARA	1:1000 FISIER ZR.06/7400
CLIENT:	S.C. COMPET S.A. PLOESTI		
PROIECTANT:	PETROSTAR S.A.		
PROIECT NR.160/4924	INLOCUIRE CONDUCTA TITEI #10 3/4" F1+F2 PANA LA CALUZI-SUSTE-POLESTI		
IN ZONA PARC 14 COBIA, LOC. BUDARI, JUD. DAMBOVITA, PE O LUNGIME DE CIRCA 570 M PE FIECARE FR			
PLAN TOPOGRAFIC			
CONDUCTE TITEI EXISTENTE SI PROIECTATA FIR 1 #10 3/4"			
DESEN NR. ZR-0674		FILA 1	REVIZIA 0

SC. DESINARE +1.00/1